

FAUX WOOD BASICS

INSTALLATION INSTRUCTIONS

1

TOOLS

GETTING STARTED - TOOLS NEEDED FOR INSTALLATION

Rechargeable Drill with 1/4" Hex Bit / Phillips Screwdriver / Pencil / Tape Measure

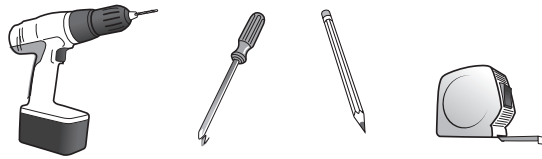

2

UNPACKING THE PARTS

Locate the parts and brackets in hardware box.
The quantity will vary with blind size.

Center Support Bracket will only be sent for blinds over 37" wide.

Installation Brackets

Valance Clips

Center Support

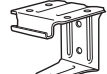
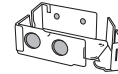

Hold-down Bracket

Installation Screws



3

BRACKET PLACEMENT

Left Bracket

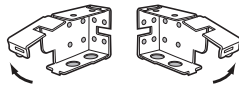

Right Bracket

IF APPLICABLE:
Center Support Bracket

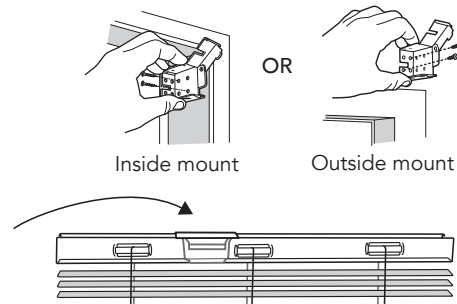
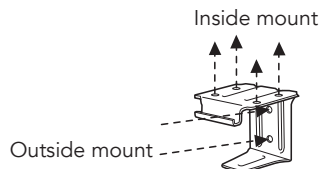

4

VALANCE CLIPS

Attach Valance Clips

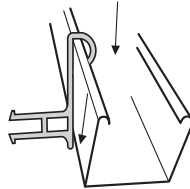
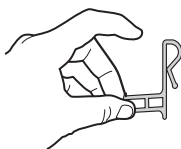

Clip on to Headrail

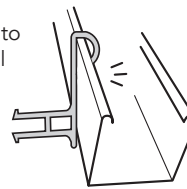

5

FINISHING UP

Slide into Brackets

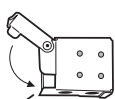
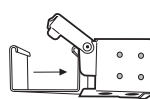
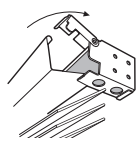

Attach Wand

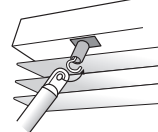

Install Valance

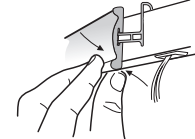

IF APPLICABLE:
Hold-down brackets

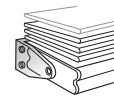
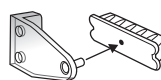

OR

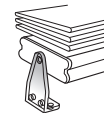

6

OPERATING INSTRUCTIONS

Raise or lower the blind by lifting or lowering the bottom rail to the desired height.

PLEASE NOTE: This product is made up to +6" of ordered height. This is normal for this product and not considered a manufacturing error or defect.

Open or close the blind slats by turning the wand until the slats are opened or closed to the desired amount.



1033590